

\$3950.00 / Monthly - 1311 - 220 MISSINNIHE WAY

Listing ID: W8386292

\$3950.00 / Monthly

2 Bedrooms, 2 Bathrooms Single Family

1311 - 220 MISSINNIHE WAY,
Mississauga, Ontario, L5H0A9

Welcome Home to the Award Winning Brightwater Community. Located Steps to the Waterfront Trails of Lake Ontario, This 2 Bedroom & 2 Bathroom Condominium Boasts Almost 1000 sq. ft. of Living Space and Features Breathtaking Views of Lake Ontario and the City of Toronto Skyline From Your Private Balcony! Step Inside From One of Two Balconies to Open Concept, Modern Luxury With Brand New Built In Appliances, Sleek Island and Ample Space to Gather Around and Entertain Family & Friends. You Won't Be Disappointed With the Convenience of Being a Short Stroll Away From The Village of Port Credit Known For It's Vibrant People, Restaurants, Shops, Festivals and Of Course the Go Station & Buses For Commuters. Don't Miss This Opportunity to Live in One of the Best Units Brightwater Has to Offer! **** EXTRAS **** Included in Lease: Building Insurance, Central Air Conditioning, Common Elements, heat, Water, Parking. (id:54154)

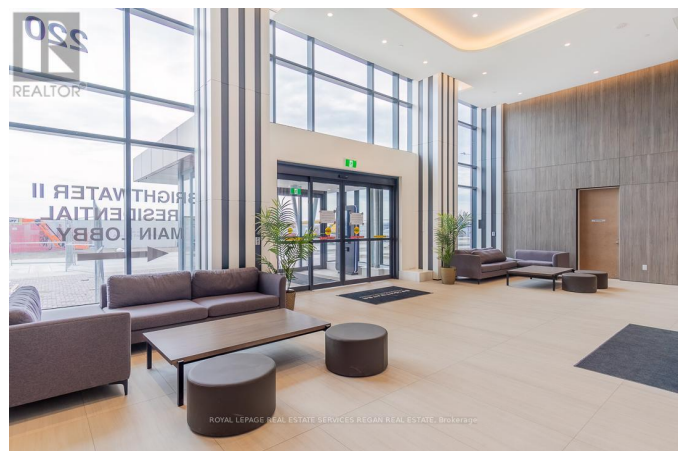

MLS®, REALTOR®, and the associated logos are trademarks of The Canadian Real Estate Association
Data Provided by: Toronto Regional Real Estate Board
Last Modified: 31/07/2024 10:48:00 AM
Listing Office:ROYAL LEPAGE REAL ESTATE SERVICES REGAN REAL ESTATE